

A-A

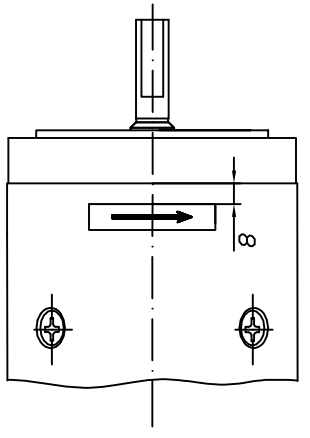

C
1:2

	DC motor	EC 0.84/2.4/25
0.84 kW	24 V	24 rpm
47 A	2500 min ⁻¹	SE-12min
2500 min ⁻¹	SE-12min	www.elprom-ems.com
SE-12min	IP 44	
www.elprom-ems.com	CCW/DE	

EC 0.84/2.4/25
0 18 12 5000

rated power 0,84 kW
 rated voltage 24 V
 rated current 47 A
 rated speed 2500 min⁻¹
 operation mode SE-12min
 excitation compound
 protection IP 44
 insulation class F
 weight 6,7 Kg
 char. curve C24A06
 rotation CCW/DE

NOTE: B - seal with silicone paste

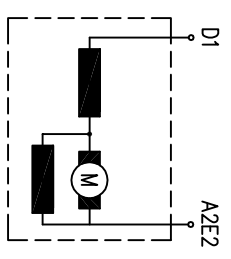

08.11.2007		Elprom-EMS
04.10.2006		
05.04.2006		
Rev.		

Torque 13
10⁺² Nm
counter

A 59